

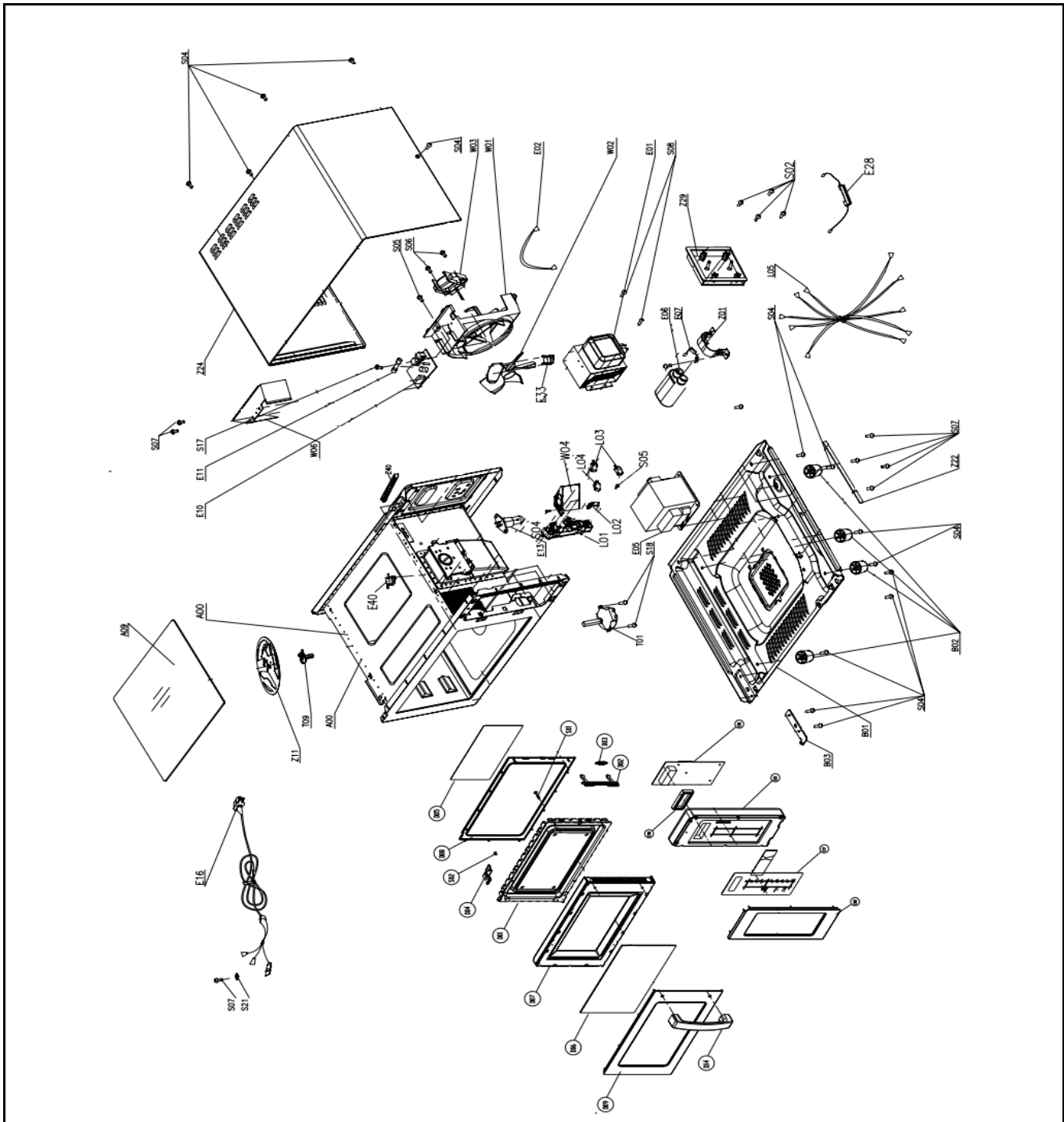

Drawing

|  |                              |                 |
|--|------------------------------|-----------------|
|  <p><b>Hendi B.V.</b><br/>Steenoven 21<br/>3911 TX Rhenen<br/>The Netherlands</p> | Batch #                      | Appliance part# |
|  | HK170599 and up              | 281444          |
|  | Description                  |                 |
|  | Microwave programmable 1000W |                 |

|          |                               |            |                  |
|----------|-------------------------------|------------|------------------|
| Date     | 12-03-2018                    | Revision # | Revision version |
| Revision | First bill of materials (BOM) |            |                  |



### Bill of materials (BOM)

|   |                    |                        |
|---|--------------------|------------------------|
| <br><b>Hendi B.V.</b><br>Steenoven 21<br>3911 TX Rhenen<br>The Netherlands | <b>Batch #</b>     | <b>Appliance part#</b> |
|   | HK170599 and up    | <b>281444</b>          |
|   | <b>Description</b> |                        |
| <b>Microwave programmable 1000W</b>   |                    |                        |

|                 |                               |                   |                  |
|-----------------|-------------------------------|-------------------|------------------|
| <b>Date</b>     | 12-03-2018                    | <b>Revision #</b> | Revision version |
| <b>Revision</b> | First bill of materials (BOM) |                   |                  |

| Item | Description                    | Part#  | Quantity | Remark                           | Picture |
|------|--------------------------------|--------|----------|----------------------------------|---------|
| C00  | Control Panel Assembly         | 943779 | 1        | Item C01;C02;17;C18;C11;C50      |         |
| C01  | Control Panel Housing          | nss    | 1        |                                  |         |
| C02  | Control Panel Housing Cover    | nss    | 1        |                                  |         |
| C17  | Membrane Switch                | nss    | 1        |                                  |         |
| C18  | Control Panel PCB              | nss    | 1        |                                  |         |
| C50  | Rubber Cover for Control PCB   | nss    | 1        |                                  |         |
| D00  | Complete Door Assembly         | 943786 | 1        | Incl. Items D01~D14              |         |
| D01  | Door Frame                     | nss    | 1        |                                  |         |
| D02  | Door Latch                     | nss    | 1        |                                  |         |
| D03  | Door Latch Spring              | nss    | 1        |                                  |         |
| D04  | Upper Hinge                    | nss    | 1        |                                  |         |
| D05  | Door Film                      | nss    | 1        |                                  |         |
| D06  | Door Screen                    | nss    | 1        |                                  |         |
| D07  | Door Panel                     | nss    | 1        |                                  |         |
| D08  | Door Gasket                    | nss    | 1        |                                  |         |
| D09  | Door Panel Cover               | nss    | 1        |                                  |         |
| D14  | Door Handle Assembly           | nss    | 1        |                                  |         |
| A00  | Housing assembly               | n/a    | 1        | Incl. items A00;T01;T09;Z11;A09  |         |
| B01  | Bottom Plate                   | n/a    | 1        |                                  |         |
| B02  | Foot                           | 943793 | 4        |                                  |         |
| B03  | Lower Hinge                    | n/a    | 1        |                                  |         |
| E01  | Beamer                         | 943809 | 1        |                                  |         |
| E05  | High Voltage Transformer       | 943816 | 1        |                                  |         |
| E06  | High Voltage Capacitor         | 943823 | 1        |                                  |         |
| E07  | High Voltage Diode             | 943830 | 1        |                                  |         |
| E10  | EMC Filter                     | 943847 | 1        |                                  |         |
| E11  | Main Fuse (10 Amp)             | n/a    | 1        | Obtain Locally                   |         |
| E13  | Lamp                           | 943861 | 1        |                                  |         |
| E16  | Powercord                      | 943878 | 1        |                                  |         |
| E28  | High voltage fuse              | 943885 | 1        |                                  |         |
| E35  | Clixon 160°C                   | 943892 | 1        |                                  |         |
| E40  | Clixon 110°C                   | 943908 | 1        |                                  |         |
| L00  | Door switch complete assembly  | 943854 | 1        | Incl item L01;L02;L03 and 2x L04 |         |
| L01  | Door Safety Base               | nss    | 1        |                                  |         |
| L02  | Door Safety Lever              | nss    | 1        |                                  |         |
| L03  | Microswitch "A"                | nss    | 2        |                                  |         |
| L04  | Microswitch "B"                | nss    | 1        |                                  |         |
| L05  | Wire Harness                   | n/a    | 1        |                                  |         |
| W01  | Fan Mounting Bracket           | n/a    | 1        |                                  |         |
| W02  | Fan Blade                      | n/a    | 1        |                                  |         |
| W03  | Fan Motor                      | 943915 | 1        |                                  |         |
| W04  | Lamp cover                     | n/a    | 1        |                                  |         |
| W06  | Wind Guide Beamer (Back Side)  | n/a    | 1        |                                  |         |
| Z01  | High Voltage Capacitor Bracket | n/a    | 1        |                                  |         |
| Z24  | Housing Cover                  | n/a    | 1        |                                  |         |
| Z29  | Cover                          | n/a    | 1        |                                  |         |
| Z40  | Housing cover                  | n/a    | 1        |                                  |         |
|      |                                |        |          |                                  |         |
|      |                                |        |          |                                  |         |
|      |                                |        |          |                                  |         |

n/a -> not available

nss -> not sold separately

## Circuit diagram

|  |                              |                        |
|--|------------------------------|------------------------|
|  <p><b>Hendi B.V.</b><br/>Steenoven 21<br/>3911 TX Rhenen<br/>The Netherlands</p> | <b>Batch #</b>               | <b>Appliance part#</b> |
|  | HK170599 and up              | <b>281444</b>          |
|  | <b>Description</b>           |                        |
|  | Microwave programmable 1000W |                        |

|                 |                               |                   |                  |
|-----------------|-------------------------------|-------------------|------------------|
| <b>Date</b>     | 12-03-2018                    | <b>Revision #</b> | Revision version |
| <b>Revision</b> | First bill of materials (BOM) |                   |                  |

